

*This detail may be used for roofs with a pitch of 12degrees minimum. Where the pitch is less than 12degrees 35mm min clearance is required between the underside of the cladding and the apron flashing

DF18 ApronFlashing - Horizontal
Palliside Rusticated profile

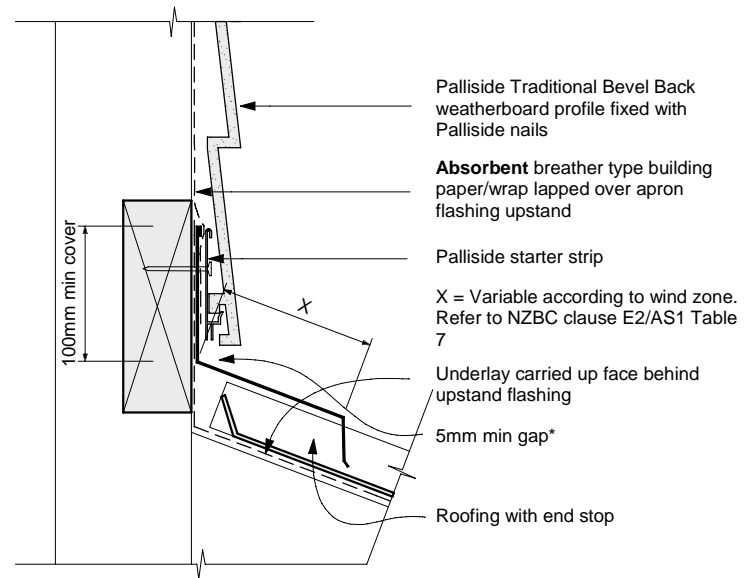

*This detail may be used for roofs with a pitch of 12degrees minimum. Where the pitch is less than 12degrees 35mm min clearance is required between the underside of the cladding and the apron flashing

DF18 ApronFlashing - Horizontal
Palliside Traditional Bevel Back profile